

Main Details:

Year of construction: 2007
Vessel Name: Furore-G
Owner: Rederij Groen B.V.
Flag: Panama
IMO Number: 9483413
Call Sign: HP 2410
MMSI: 370856000
Class : Lloyds Register
 I + A . Mach . AUT – UMS Special
 service
 Unrestricted 200 Nm from shore
 Offshore Support Vessel
 Sea area GMDSS A2

Dimensions:

L.o.a : 34.42 Mtrs.
Width : 7.05 Mtrs.
Draught : 1.60 Mtrs.
Net Tonnage : 62 NT
Gross Tonnage : 206 GT

Propulsion system:

Main engines : 2 x Caterpillar C 32 V 12
Total power : 2 x 1044 kW (Total 2088 kW)
Gearboxes : 2 x Reintjes
Propellers : 2 x fixed pitch propellers 5 blade
Bow thruster : 1 x 100 KW hydraulically driven

Steering gear:

Twin Rudders with Sperry steering gear with FU / NFU and local control + emergency control

Hull Material:

Hull : Steel
Superstructure : Aluminum

Specifications “MV Furore-G” Offshore Support Vessel



Electrical Equipment:

Network : 24 V D.C., 230 V / 400 V 50 Hz
Generator set : 2x Generator set Caterpillar C 4.4
 Power management / auto-start
Capacity : 2 x 34 kVA / 27 kW
Harbor generator: 1x Hatz 3L41C 15 kW

Deck equipment:

- Slipway and hydraulic operated stern gate for FRC deployment and retrieval
- Hydraulic operated capestand
- FRC with inboard Diesel engine and waterjet
- MGO fuel transfer pump to refuel small boats and workboats
- Boarding gates in ps and stb bulwark

Tank capacity:

Fuel oil : 22 M³
Fresh water : 5.40 M³
Waste water : 1.40 M³
Bilge water : 1.94 M³
Dirty oil : 560 ltr
Lube Oil Storage : 560 ltr

Fuel consumption:

ltr / hr @ 15.5 knots
ltr / hr @ 12 knots
ltr / hr @ 8knots

Communication & Navigation Equipment:

Modern navigational aids on board
Vessel is equipped for GMDSS A2

X-band radar	: 2 x JRC JMA5212
GPS-receiver	: 1 x Furuno GP-170 1 x JRC NWZ 4570
GMDSS VHF/DSC	: 2 x Sailor RT-6222
GMDSS VHF/DSC	: 1 x Sailor RT-5022
GMDSS Handheld	: 2 x McMurdo
MF / HF DSC radio	: 1 x Sailor HT4610 , 250W
Radio direction finder	: 1 x Taiyo TD- L1550A
Gyro Compass	: 1 x Alphanon mini course
AIS system	: 1 x JRC JHS 182
Magnetic compass	: 1 x Cassens & Plath 22
Autopilot	: 1 x Anschutz NP 60
Echo sounder	: 1 x JRC / JFE 380 50 200 KHz
Wind indicator	: 1 x Alphanon multi wind
Navtex	: 1 x JRC / NCR 333
Epirb	: 1 x Jotron Tron60S
SART	: 2 x Jotron Tronsart
Satelitephone	: 1 x Iridium Pilot
VSAT	: 1 x Intellian V100
Wi-Fi	: in accommodation
Ships computer	: 2 x PC workstations with internet and printer

Special features:

- **FW Maker** : Horizon Seafari
Capacity : 10 m3 / 24 hr
- **Sewage treatment system**
- **Searchlights** : 2 x 1000 Watt
- **Intercom / PA system** : Alphanon / Alpha call
- **CCTV camera system** :
Engine room / Forecastle deck / Aft deck
- **Helicopter winching zone** : On foredeck
- **MOB recovery equipment** : Jason Cradle
: Mob Hoist
- **Rescue zones**: Rescue zone on both sides

Accommodation (fully air conditioned):

Cabins	: 4 single crew cabins : 2 double cabins
Bunks	: Total 8 bunks
Mess room / Dayroom	(Wi-Fi included)
Pantry/ Galley	fully equipped
Reception / changing area	
Office	with Wi-Fi and internet

Other Capacities:

Minimum Crew	: 5
Maximum Crew	: 8
Industrial Personnel / PAX	: 12
Deck space	: 15 M ² :
Life rafts	: 2 x 20 pers Viking S30

Speed:

Max Speed	: 15.5 knots
Cruising Speed	: 12 knots

KM-G
FIRE CONTROL AND LIFE SAVING PLAN
 IMO NO: 9608776

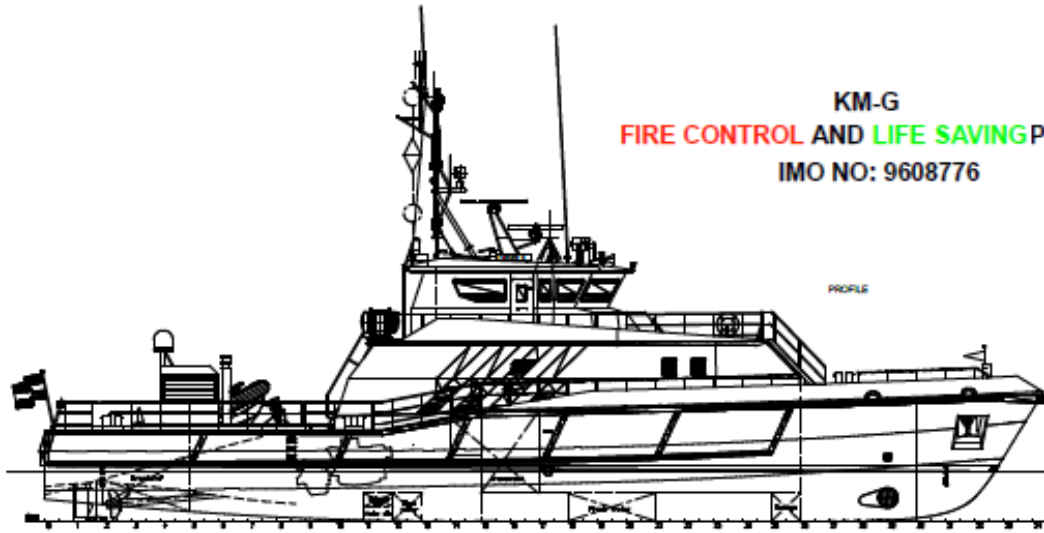

PROFILE



BRIDGE DECK TOP

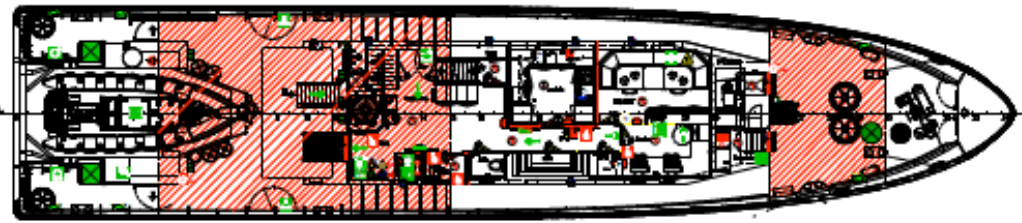
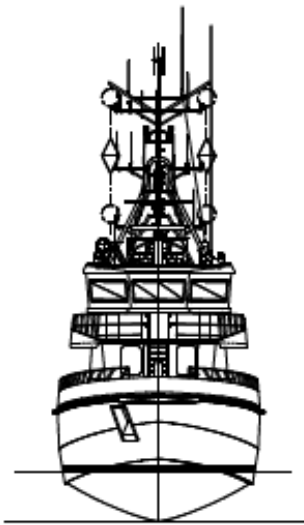

MAIN DECK



BRIDGE DECK

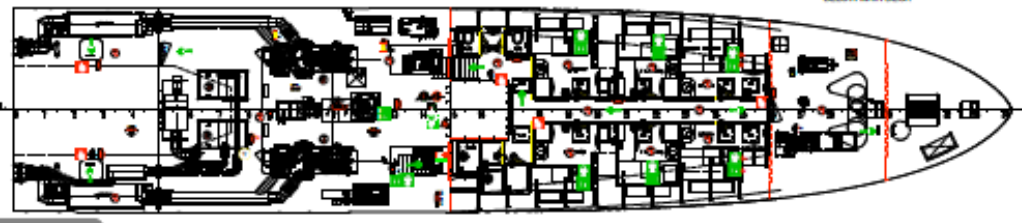

BELOW MAIN DECK

SHIP'S REGISTRATION
 SHIP'S NAME: PAPERBILT
 CALL SIGN: HPIR
 PORT OF REGISTRY: PANAMA
 MMSI NO: 311000000
 AISC NO: 0000000000
 GROSS TONNAGE: 208

PERSONNEL CAPACITY AND
 LENGTH (L.P.A.): 28.00M
 BEAM (M.L.C.): 7.00M
 DRAUGHT (M.D.): 1.80M
 COMPLIANCE: 8 NOV 11

LIFE SAVING PLAN		NO	UNIT	QTY	LOCATION
1	RESCUE BOAT BOARD: IMPROVABLE W.O.S.				
2	INFLATABLE LIFE RAFT 20 PERSONS				
3	LIFE BUOY WITH SOL LIGHT				
4	LIFE BUOY WITH LIGHT				
5	LIFE BUOY WITH LIGHT + SMOKE SIGNAL				
6	LIFE JACKETS				
7	AMBIBROACH SUITS				
8	SHOWER STATION				
9	SHOWER PORTABLE RADIO				
10	STOVE				
11	SAFETY TAGS TRANSFORMER				
12	ROCKET PARACHUTE FLARES				
13	LIFE THROWING APRON				
14	SECURITY NET MAIN OVER BOARD				
15	STRETCHER				
16	MEDICAL LOCKER				
17	AUTOMATED EXTERNAL DEPRESSURIZER				
18	EMERGENCY ESCAPE SWITCHING DEVICE				
19	EYE WASH STATION				
20	EMERGENCY SHOWERS				
21	PUBLIC ADDRESS SYSTEM				
22	LOADING P.A. SYSTEM				
23	EMERGENCY TELEPHONE STATION				
24	MEDICAL SYSTEM				
25	WATER STATION				
26	REARRANGEMENT STATION				
27	ESCAPE HATCH				
28	PRIMARY ESCAPE ROUTE				
29	SECONDARY ESCAPE ROUTE				

FIRE CONTROL PLAN		NO	UNIT	QTY	LOCATION
1	FIRE EXTINGUISHER A				
2	FIRE EXTINGUISHER B				
3	FIRE EXTINGUISHER C				
4	STORAGE BINNS EXTINGUISHERS				
5	FIRE BLANKET				
6	FIRE HYDRANT				
7	FIRE HOSE WITH SPRAY NOZZLE				
8	WATER HOSE ON REEL WITH SPRAY NOZZLE				
9	PORTABLE FOG EXTINGUISHER A				
10	FOG APPLICATOR				
11	SHOWER FOG NOZZLE INSTALLATION				
12	EXTINGUISHER HOSE INSTALLATION				
13	FOG PROTECTIVE BY NOZZLE INSTALLATION				
14	FOGGY ALARM				
15	COMBINED PRESSURE END OF PUMP				
16	COMBINED PRESSURE PUMP				
17	EMERGENCY FOG PUMP				
18	REMOTE CONTROL FOR FOG BUOY BACKUP PUMP				
19	REMOTE CONTROL FOR FOG BUOY PUMP				
20	HYDRANTIAL HOSE CONNECTION				
21	CENTRAL PANEL FIRE CONTROL ALARM				
22	MANUAL FOG BUOY ALARM				
23	SMOKE DETECTOR				
24	HEAT DETECTOR				
25	FLAME DETECTOR				
26	CONTROL AND INDICATOR PANEL ALARM				
27	ALARM BELL				
28	CENTRAL ALARM FROM BATTERY				
29	EMERGENCY LIGHT (FIRE CLASS A)				
30	EMERGENCY LIGHT (FIRE CLASS B)				
31	EMERGENCY LIGHT (FIRE CLASS C)				
32	EMERGENCY LIGHT (FIRE CLASS D)				
33	EMERGENCY LIGHT (FIRE CLASS E)				
34	EMERGENCY LIGHT (FIRE CLASS F)				
35	EMERGENCY LIGHT (FIRE CLASS G)				
36	EMERGENCY LIGHT (FIRE CLASS H)				
37	EMERGENCY LIGHT (FIRE CLASS I)				
38	EMERGENCY LIGHT (FIRE CLASS J)				
39	EMERGENCY LIGHT (FIRE CLASS K)				
40	EMERGENCY LIGHT (FIRE CLASS L)				
41	EMERGENCY LIGHT (FIRE CLASS M)				
42	EMERGENCY LIGHT (FIRE CLASS N)				
43	EMERGENCY LIGHT (FIRE CLASS O)				
44	EMERGENCY LIGHT (FIRE CLASS P)				
45	EMERGENCY LIGHT (FIRE CLASS Q)				
46	EMERGENCY LIGHT (FIRE CLASS R)				
47	EMERGENCY LIGHT (FIRE CLASS S)				
48	EMERGENCY LIGHT (FIRE CLASS T)				
49	EMERGENCY LIGHT (FIRE CLASS U)				
50	EMERGENCY LIGHT (FIRE CLASS V)				
51	EMERGENCY LIGHT (FIRE CLASS W)				
52	EMERGENCY LIGHT (FIRE CLASS X)				
53	EMERGENCY LIGHT (FIRE CLASS Y)				
54	EMERGENCY LIGHT (FIRE CLASS Z)				
55	EMERGENCY LIGHT (FIRE CLASS AA)				
56	EMERGENCY LIGHT (FIRE CLASS AB)				
57	EMERGENCY LIGHT (FIRE CLASS AC)				
58	EMERGENCY LIGHT (FIRE CLASS AD)				
59	EMERGENCY LIGHT (FIRE CLASS AE)				
60	EMERGENCY LIGHT (FIRE CLASS AF)				
61	EMERGENCY LIGHT (FIRE CLASS AG)				
62	EMERGENCY LIGHT (FIRE CLASS AH)				
63	EMERGENCY LIGHT (FIRE CLASS AI)				
64	EMERGENCY LIGHT (FIRE CLASS AJ)				
65	EMERGENCY LIGHT (FIRE CLASS AK)				
66	EMERGENCY LIGHT (FIRE CLASS AL)				
67	EMERGENCY LIGHT (FIRE CLASS AM)				
68	EMERGENCY LIGHT (FIRE CLASS AN)				
69	EMERGENCY LIGHT (FIRE CLASS AO)				
70	EMERGENCY LIGHT (FIRE CLASS AP)				
71	EMERGENCY LIGHT (FIRE CLASS AQ)				
72	EMERGENCY LIGHT (FIRE CLASS AR)				
73	EMERGENCY LIGHT (FIRE CLASS AS)				
74	EMERGENCY LIGHT (FIRE CLASS AT)				
75	EMERGENCY LIGHT (FIRE CLASS AU)				
76	EMERGENCY LIGHT (FIRE CLASS AV)				
77	EMERGENCY LIGHT (FIRE CLASS AW)				
78	EMERGENCY LIGHT (FIRE CLASS AX)				
79	EMERGENCY LIGHT (FIRE CLASS AY)				
80	EMERGENCY LIGHT (FIRE CLASS AZ)				
81	EMERGENCY LIGHT (FIRE CLASS BA)				
82	EMERGENCY LIGHT (FIRE CLASS BB)				
83	EMERGENCY LIGHT (FIRE CLASS BC)				
84	EMERGENCY LIGHT (FIRE CLASS BD)				
85	EMERGENCY LIGHT (FIRE CLASS BE)				
86	EMERGENCY LIGHT (FIRE CLASS BF)				
87	EMERGENCY LIGHT (FIRE CLASS BG)				
88	EMERGENCY LIGHT (FIRE CLASS BH)				
89	EMERGENCY LIGHT (FIRE CLASS BI)				
90	EMERGENCY LIGHT (FIRE CLASS BJ)				
91	EMERGENCY LIGHT (FIRE CLASS BK)				
92	EMERGENCY LIGHT (FIRE CLASS BL)				
93	EMERGENCY LIGHT (FIRE CLASS BM)				
94	EMERGENCY LIGHT (FIRE CLASS BN)				
95	EMERGENCY LIGHT (FIRE CLASS BO)				
96	EMERGENCY LIGHT (FIRE CLASS BP)				
97	EMERGENCY LIGHT (FIRE CLASS BQ)				
98	EMERGENCY LIGHT (FIRE CLASS BR)				
99	EMERGENCY LIGHT (FIRE CLASS BS)				
100	EMERGENCY LIGHT (FIRE CLASS BT)				
101	EMERGENCY LIGHT (FIRE CLASS BU)				
102	EMERGENCY LIGHT (FIRE CLASS BV)				
103	EMERGENCY LIGHT (FIRE CLASS BU)				
104	EMERGENCY LIGHT (FIRE CLASS BV)				
105	EMERGENCY LIGHT (FIRE CLASS BU)				
106	EMERGENCY LIGHT (FIRE CLASS BV)				
107	EMERGENCY LIGHT (FIRE CLASS BU)				
108	EMERGENCY LIGHT (FIRE CLASS BV)				
109	EMERGENCY LIGHT (FIRE CLASS BU)				
110	EMERGENCY LIGHT (FIRE CLASS BV)				



OK

DATE: 10-10-2017

BY: [Signature]

FOR: [Signature]

23,63 in

Rederij Groen BV
 www.rederijgroen.nl
 Email: info@rederijgroen.nl
 Telephone +31 70 355 35 88

All particulars believed to be correct but not guaranteed.

Version 2017-10-17

