

Specifications: Seismic Research Support Vessel "Linde-G"

Year of construction: 2018
Vessel Name: "Linde-G"
Flag: Marshall Islands
IMO number : 9731298
Call Sign: V7A2093
Class : Lloyds Register
 ✕100A1 SSC Patrol
 MONO, G6
 MCH, UMS, DP(AM)

Dimensions:

L.o.a : 57.65 Mtrs.
 Width : 9.00 Mtrs.
 Draught : 3.10 Mtrs
 Gross tonnage : 496 T
 Net tonnage : 148 T

Main engine(s):

Direct drive : 2x 2350 kW Caterpillar 3516C
 Diesel-Electric drive : 2x 350kW

Aux power:

Caterpillar 9.3 : Stamford 300kW/375kVA
 Caterpillar 4.4 : Stamford 99kW/123kVA
 Shaft generator : LeRoy Sommer 800kW @ 1500rpm

Propulsion System :

Propellers : 2x fixed pitch Bronze
 Bow thrusters : 1x Veth/Rotor 135kW @ 1800rpm
 Rudders : 2x 90° manoeuvring, 2x 40° at sea

Crane(s)/Lifting material/ deck equipment

Crane : 2T @ 14m. 50m/min
 Workboat davit : 12T Vestdavit
 Rescue net : Dacon Scoop
 Rescue zones : Gates + swing ropes in PS & SB bulwarks

Communication Equipment GMDSS A3

MF/HF Radio : 1x JRC JSS 2150
 VHF DSC : 3x Sailor RT 6222
 SAT C + LRIT : 1x JRC JUE 87
 SAT C + LRIT : 1x JRC JUE 87
 Portable VHF : 3x Sailor SP 3520
 A.I.S. : 1x JRC JHS 183
 E.P.I.R.B. : 1x Mc Murdo G8

VSAT : Sailor 900
 Iridium : IOP Pilot , with back up email
 PA system: : Alphaconnect
 Satellite Television: KVH M9

Fuel economy:

Hull Vane[®] fitted
 Diesel-electric drive consumes only approx. 75kW at 5 kts
 Fuel consumption monitoring



Navigation Equipment:

ARPA Radar : 2x JRC JMR 5410 X-band
 DGPS Navigation : 1x GPS C-NAV 3050,
 1x Glonass Trimble SPS351
 GPS : 1x JRC JLR 7800
 Navtex : 1x JRC NCR 333
 Magnetic compass: 1x Alphanon SR 4
 Sat.Compass : 1x JRC JLR 21
 Automatic Pilot : 1x Navis (integrated in DP system)
 : 1x Alphapilot (standalone pilot)
 Electronic Charts : 1x full duplex ECDIS Tranas
 Navisailor 4100
 Searchlights : 1x forward facing 1000 Watt
 : 1x Aft facing Watt
 CCTV : Engine spaces / public areas /
 Work deck / Pax area.
 DP System (DP1) : Navis
 Joystick System : Navis C-Joy, bridge mounted and
 remote control unit
 ADCP / Current meter: Nortek VMCP 600 khz
 Incl. Interface box and dedicated
 bridge pc for client usage with pre-
 wired gyro and gps interface.
 TS-Dip winch : Pomek DW 500 SS, with 3000
 mtr dynema rope

Bunker / Storage capacity:

Fresh Water : 44.0 m³ + 2x RO watermakers @
 8m³ / 24 hr each
 Fuel Oil : 164.0 m³
 Clear Deck : approx. 160 m²
 Sewage holding : 27.9m³
 Reefer(s) : 1x 20ft reefer fitted
 Deck container(s) : 2x 10 ft storage containers fitted
*(Additional container slots are available for client
 equipment)*

Speed/Fuel Consumption: *

Max Speed : 19,5 knots (600ltr/hr)
 Eco Speed : 13,0 knots (130ltr/hr)
 Guard/Standby : 4,5 knots (33 ltr/hr)
 (*according to yard newbuild spec, to be proven)

Accommodation (fully air conditioned):

Accommodation : 2x single (1P) cabins
 : 2x double(2P) cabins
 : 2x four persons (4P) cabins

All cabins fitted with ensuite shower / toilet.
 All cabins fitted with wired LAN and WiFi

Pax Area

55 passenger seats
 WiFi
 Storage racks for hand luggage
 Buffet with coffee / Tea / water / softdrinks
 TV monitors for SAT TV or Video presentations

Side view SB

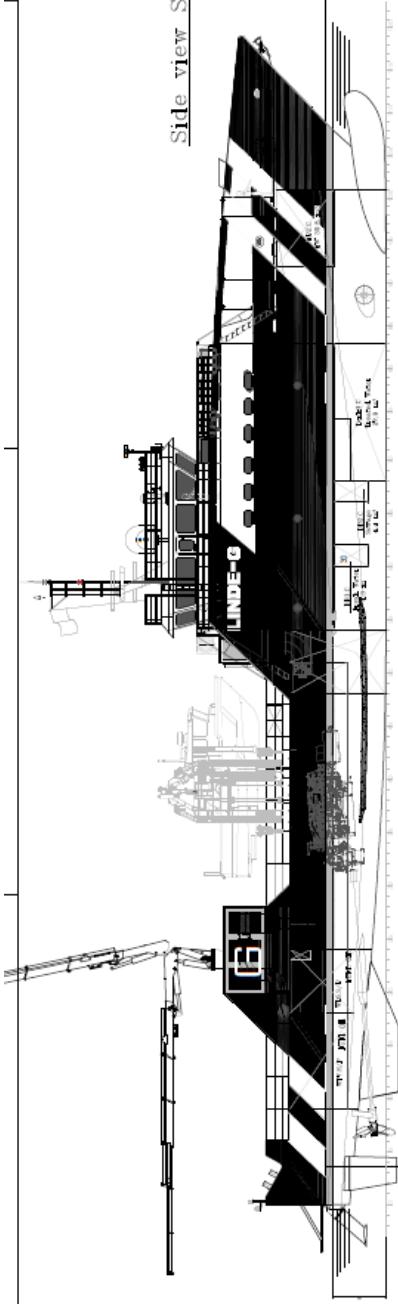

Top-Deck

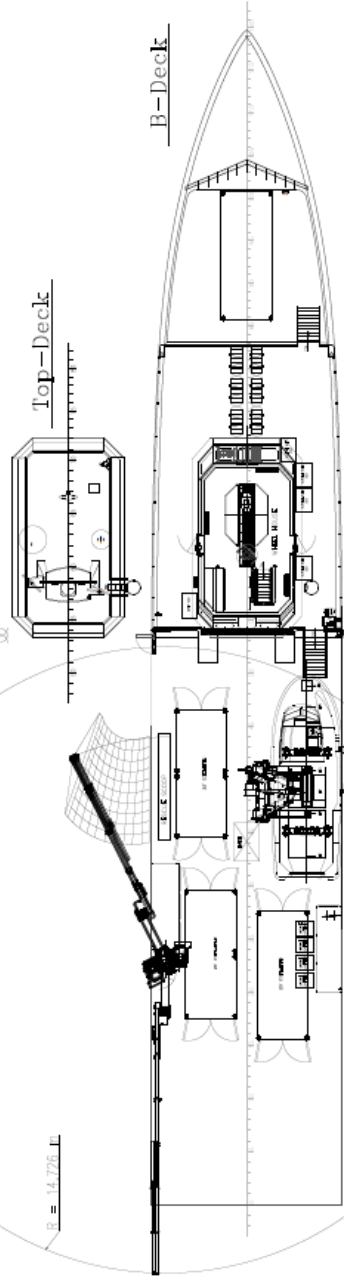

B-Deck

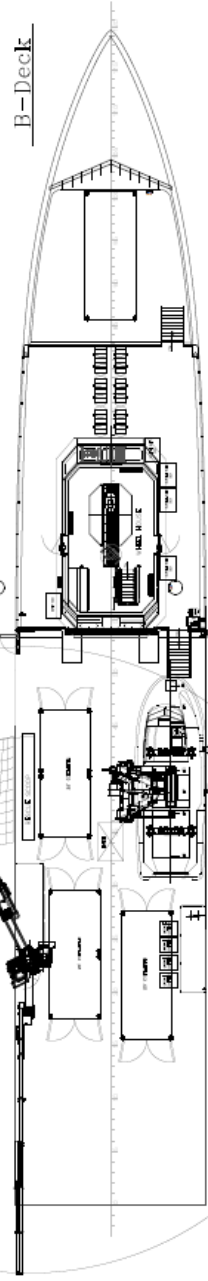

A-Deck

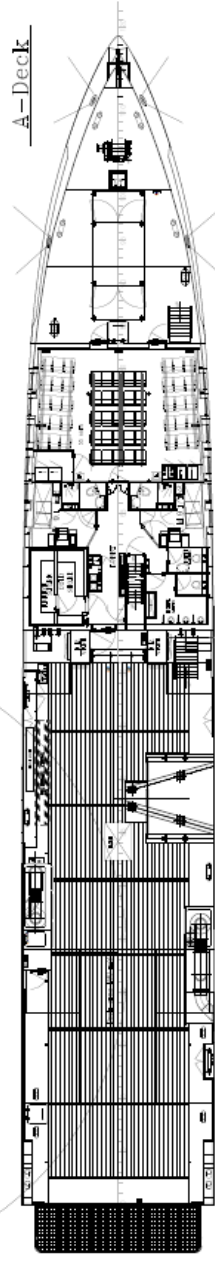

Lower Deck

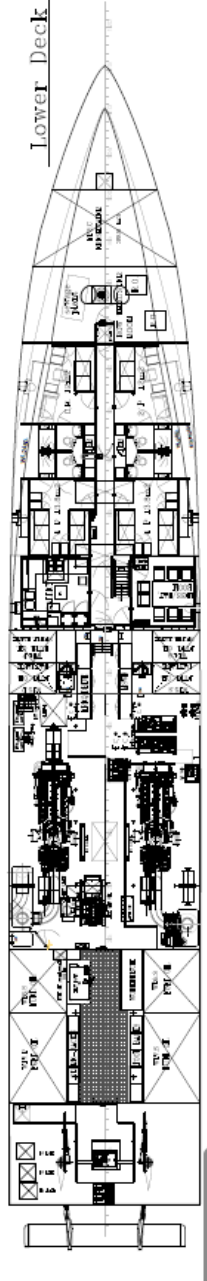

Technical Space

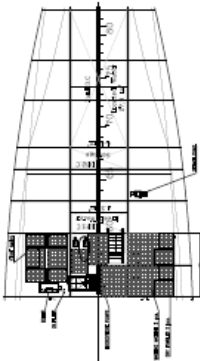

GENERAL DIMENSIONS

- LENGTH OVER ALL 55.24 M
- LENGTH BETWEEN P.P. 49.91 M
- LENGTH WATERLINE (8.50 m) 50.51 M
- BEAM 11.76 M
- DEPTH 4.90 M
- DRAUGHT 3.10 M
- DECK BEATINGS 20 DT
- DECK BEATINGS 240 EXK
- PASSENGERS 55 PERSONS
- PERF DECK SEAM APPROX 160 M
- PERF DECK SEAM 165 M
- PERF DECK SEAM 14 M

SHIP'S NO. 455/456/457/458/459

APPROVED CLASSIFICATION	SCALE	DATE	SHEET OF	DATE
CLASSIFICATION	1:100	TB	1-1	03/14
CLIENT	DESIGNED	DATE	GENERAL ARRANGEMENT	
PROJECT	PROJECT	DATE	JULY 2020	
CLIENT	PROJECT	DATE	JULY 2020	



33.11 x 23.39 in