

Main Details:

Year of construction: 2003
Vessel Name: Sea Enterprise
Flag: Panama
IMO Number: 9266633
Call Sign: VQGC9
MMSI: 235008179
Class : Lloyds Register
 I + . 100A 1 SSC G3 Workboat
 Unrestricted 150 Nm from shore
 Offshore Support Vessel
 Sea area GMDSS A2

Dimensions:

L.o.a : 27.76Mtrs.
Width : 6.59 Mtrs.
Draught : 1.40 Mtrs.
Net Tonnage : 62 NT
Gross Tonnage : 95.21 GT

Propulsion system:

Main engines : 2 x Cummins KTA 19 M4
Waterjet : 1 x Cummins Ultrajet 305
Total power : 2 x 522 KW 1x 55 KW (Total 1099 kW)
Gearboxes : 2 x Reintjes
Propellers : 2 x fixed pitch propellers 3 blade

Steering gear:

Twin Rudders with Sperry steering gear with FU / NFU and local control + emergency control

Hull Material:

Hull : Aluminum
Superstructure : Aluminum



Electrical Equipment:

Network : 24 V D.C., 230 V / 400 V 50 Hz
Generator set : 2x Generator set Cummins
 Power management / auto-start
Capacity : 2 x 34 kVA / 27 kW

Deck equipment:

- Slipway and hydraulic operated stern gate for FRC deployment and retrieval
- Hydraulic operated capestand
- FRC with 40 hp outboard engine
- MGO fuel transfer pump to refuel small boats and workboats
- Boarding gates on ps and stb bulwark and dive platform

Tank capacity:

Fuel oil : 16 M³
Fresh water : 4 M³
Waste water : 2 M³
Bilge water : 0.8 M³
Dirty oil : 400 ltr
Lube Oil Storage : 200 ltr

Fuel consumption:

ltr / hr @ 24 knots
ltr / hr @ 17 knots
ltr / hr @ 8 knots

Communication & Navigation Equipment:

Modern navigational aids on board
Vessel is equipped for GMDSS A2

X-band radar	: 2 x JRC JMA5212
GPS-receiver	: 1 x Furuno GP- 90 1 x Furuno GP-170
GMDSS VHF/DSC	: 2 x Furuno FM-8500
GMDSS VHF/DSC	: 1 x Furuno DSC-80
GMDSS Handheld	: 2 x McMurdo
MF / HF DSC radio	: 1 x Furuno FS-1562-15
Gyro Compass	: 1 x Furuno SC-50
AIS system	: 1 x Furuno FA-150
Magnetic compass	: 1 x Cassens & Plath 22
Autopilot	: 1 x Robertson AP45
Echo sounder	: 1 x Furuno 50 200 KHz
Wind indicator	: 1 x Furuno multi wind
Navtex	: 1 x JRC / NCR 333
Epirb	: 1 x Jotron Tron60S
SART	: 2 x Jotron Tronsart
Satelitephone	: 1 x Iridium Pilot
VSAT	: 1 x Intellian V100
Wi-Fi	: in accommodation
Ships computer	: 2 x PC workstations with internet and printer

Special features:

- FW Maker : Idromar MC2J
Capacity 3600 ltr 24 hr
- Sewage treatment system
- Searchlights : 1 x 1000 Watt
- Intercom / PA system : Phontech
- CCTV camera system :
Engine room / Forecastle deck / Aft deck
Helicopter winching zone : On aftdeck & Foredeck
- **MOB recovery equipment** : Jason Cradle
: Mob Hoist
- **Rescue zones**: Rescue zone on both sides and rear

Accommodation (fully air conditioned):

Cabins : 6 single crew cabins
Bunks : Total 6 bunks
Mess room / Dayroom (Wi-Fi included)
Pantry/ Galley fully equipped
Reception / changing area

Other Capacities:

Minimum Crew : 4
Maximum Crew : 6
Industrial Personnel / PAX : 12
Deck space : 80 M² :
Life rafts : 3 x 16 pers zodiac

Speed:

Max Speed : 24 knots
Cruising Speed : 17 knots

DWG No: 2215-01A-01-01
 REV: 01
 DATE: 17 FEB 2003
 PROJECT: 2215-01A-01-01

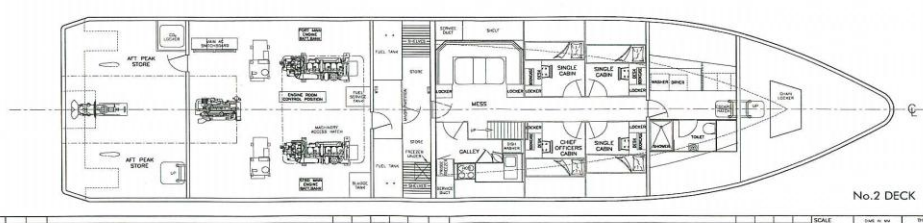
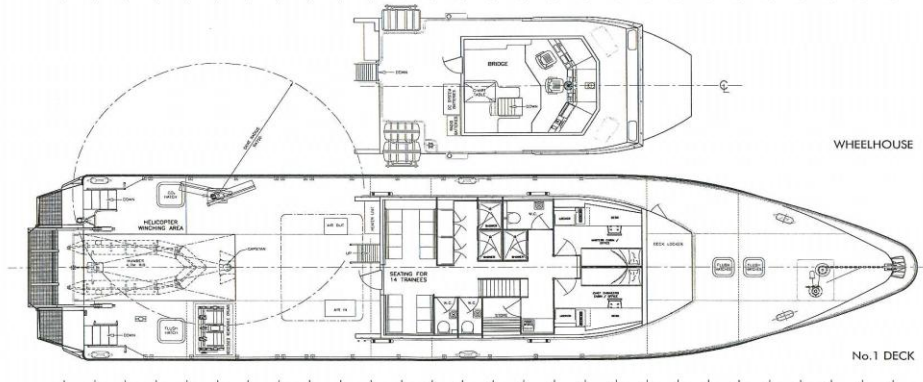
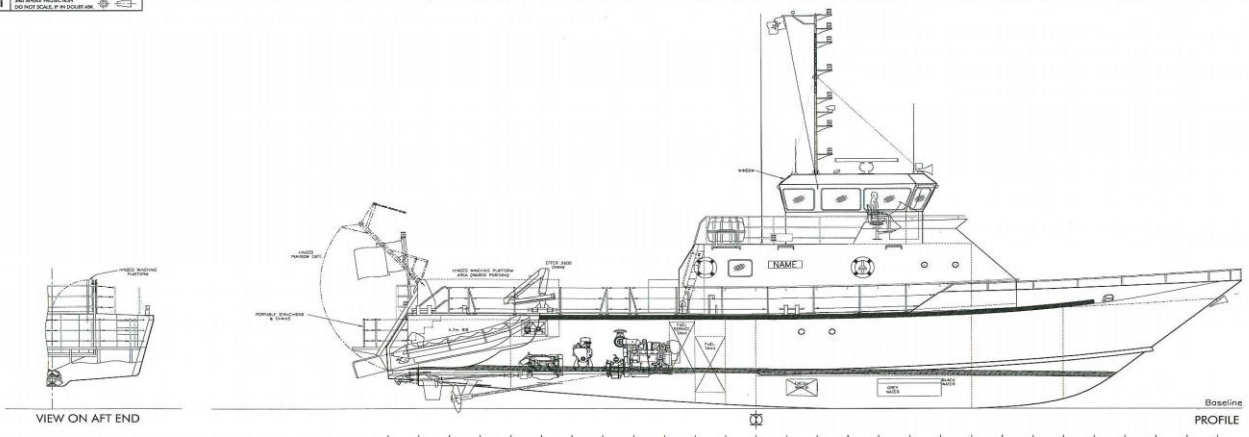

FBM
 BABCOCK MARINE
 17 FEB 2003

PRINCIPAL DIMENSIONS:-	
LENGTH OVERALL	27.60 METRES
LENGTH WATERLINE	24.00 METRES
BEAM OVERALL	6.80 METRES
BATH WATERLINE	1.50 METRES
DEPTH AT MIDSHIP	3.28 METRES

NO.	DESCRIPTION	DATE	BY	CHECKED	SCALE	DATE	BY	CHECKED	SCALE	DATE	BY	CHECKED
1	ISSUED FOR PRODUCTION				1:50							
2	REVISION											
3	REVISION											
4	REVISION											
5	REVISION											

FBM BABCOCK MARINE LTD.
 5 TOWN QUAY
 SOUTHAMPTON
 HANTS
 SO14 2PL U.K.
 TEL: +44 (0)1703 500 000
 FAX: +44 (0)1703 500 001
 E-MAIL: INFO@FBM.CO.UK
 WWW.FBM.CO.UK

GENERAL ARRANGEMENT (WORKBOAT)
 PROJECT No: 2215
 DWG No: 2215-01A-01-01
 SHEET No: 1 OF 3

Rederij Groen BV
 www.rederijgroen.nl
 Email: info@rederijgroen.nl
 Telephone +31 70 355 35 88

All particulars believed to be correct but not guaranteed.

Version 2017-10-17

